

Lea Anne Gardens

PINSON



ENERGY SMART NEW HOMES

Birmingham's Leading Energy Efficient Garden Home Builder



6140 Judy Cir

\$169,900

6245 Anne Dr

\$169,900

NO MONEY DOWN

USDA FINANCING AVAILABLE

**BUILDER PAYS \$3000 TOWARD CLOSING COSTS
WITH PREFERRED LENDER***

For more information call or email:

GEORGE HOLMAN

205.222.9892

George@EnergySmartNewHomes.com



EnergySmart
New Homes

View all Plans & Neighborhoods at
www.EnergySmartNewHomes.com

Lea Anne Gardens

PINSON

Judy Circle, Pinson, AL 35126

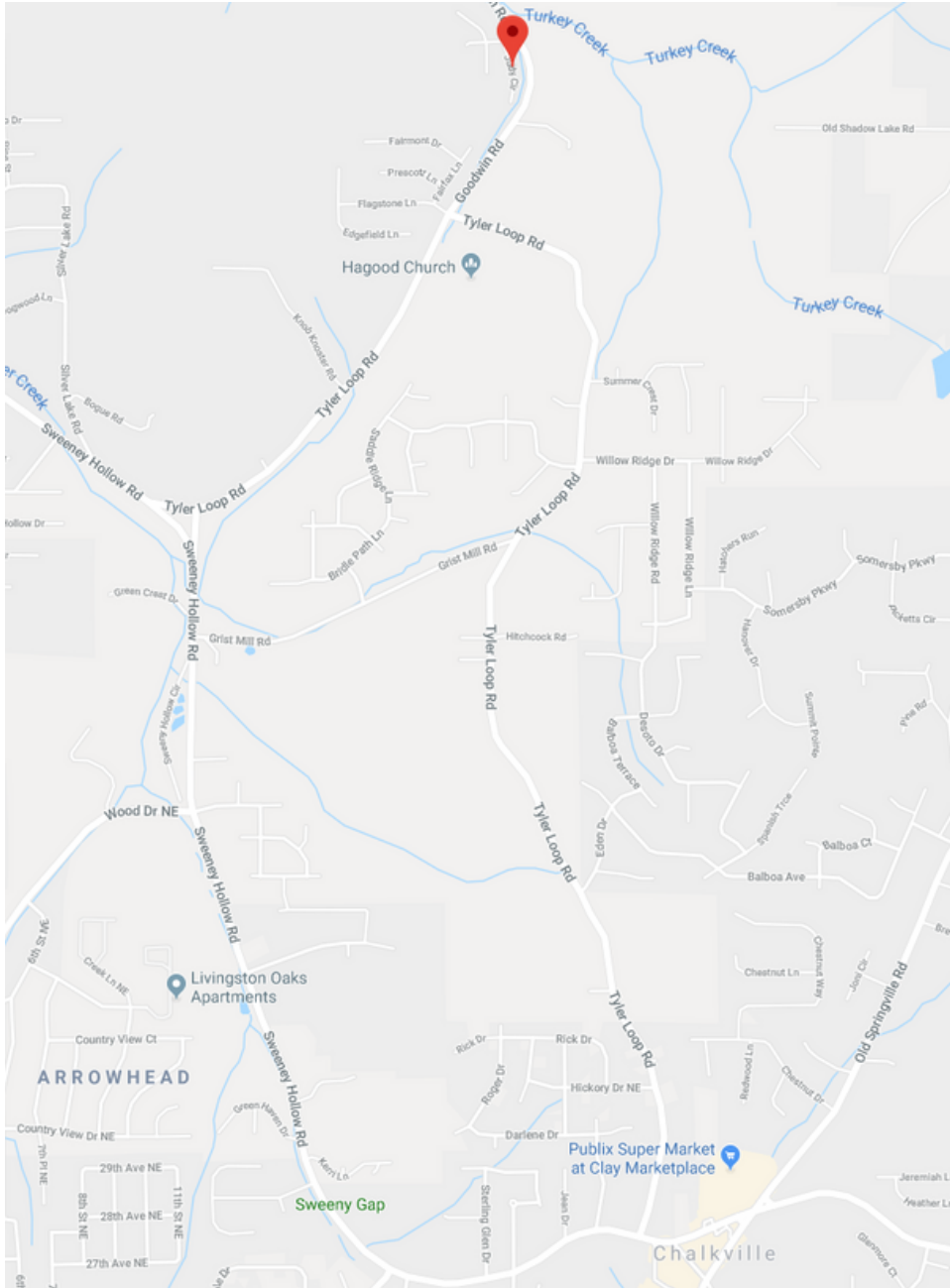

ENERGY SAVING FEATURES

- Spray Foam Insulation in all Exterior Walls & Attic
- Heat Pump Hot Water Heater
- Low-E Glass Windows
- 2 Year High Performance Guarantee for Power Bill

NEIGHBORHOOD AMENITIES

- Minutes to excellent shopping & conveniences
- Street lights
- Sidewalks

ALSO BUILDING IN

NEWFOUND COVE
MOUNT OLIVE

The **Gardens**
of Paradise Valley
CLAY



EnergySmart
New Homes

6140 Judy Cir
6245 Anne Dr
\$170,900

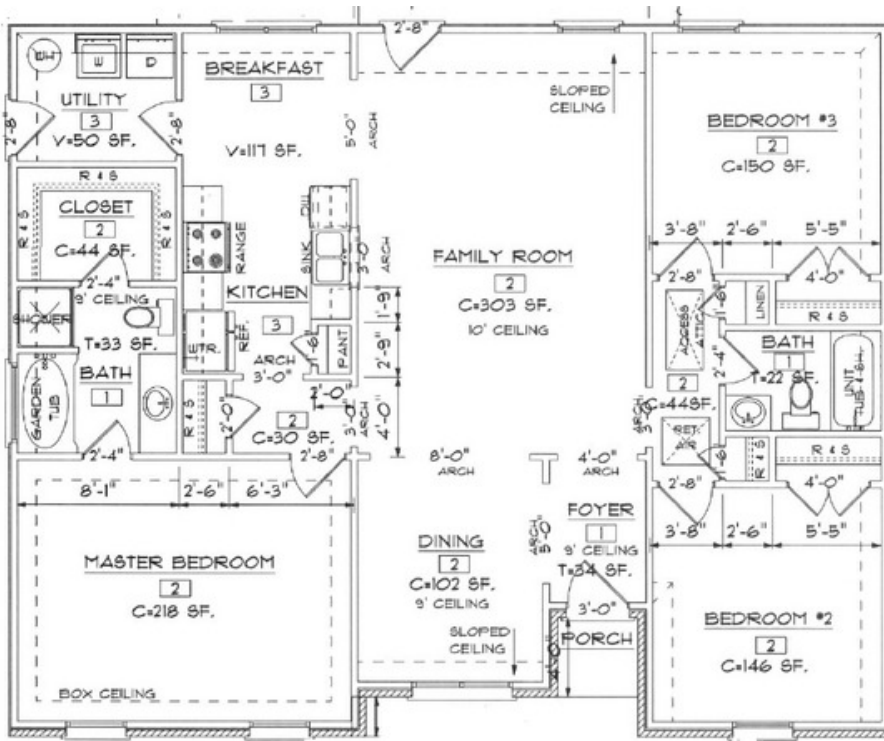

Living: 1526 SF
Covered Front Porch: 16 SF
Concrete Back Patio: 160 SF

- 3 Bedroom / 2 Bath
- Separate Dining Room
- Very Open Floor Plan
- 10' Ceilings in Family Room & Foyer
- Eat in Kitchen with Breakfast Area
- Large Laundry
- Separate Soaking Tub & Shower in Master
- Stainless Steel Appliances
- Ceiling Fans in Master & Family Room
- Attic Access from Inside Hall
- Maintenance Free Exterior
- High Efficiency Vinyl, Low E Glass Windows
- 40 Gallon Rapid Recovery Heat Pump Hot Water Heater
- Open-cell Sprayed Foam Insulation
- Smoke Detectors
- Telephone Jacks/TV Cable Outlets
- 500 Yards of Bermuda Sod with Shrubs & Shade Tree
- Termite Bond
- Builders Warranty for 1 Full Year